

## 146-B-54F - SPEEDLINE System Data Sheet - Version V1 (24-10-23)

SPEEDLINE 146mm 'C' Stud Partition @600mm  
Ctrs, with BG Gyproc 15mm SoundBloc F each side

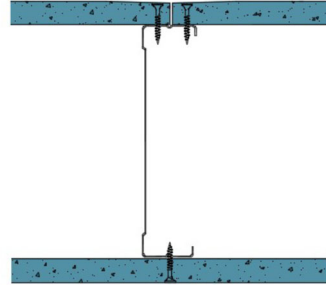

### System Performance Breakdown

Fire Resistance:

BS476 Part 22:1987:

Test Ref & Date or Applied Ref & Report:

Max Height:

Thickness:

Duty Grade: BS 5234: Part 2:1992:

Sound Insulation:

**60/60 Minutes** (Integrity/Insulation).

**BMT/FEP/F14106 - BRE Report P102396-1011A**

**Refer to Speedline Specification Clause**

**178 mm.** (At Base Track, Excluding Finishes)

**Heavy - Annexes A-F**

**47  $R_w$ dB**, Date Tested or Assessed Against - 146-B-54

Test Code:  
H19435AA  
Test Date:  
02/02/2016

Freq. Hz	R dB
50	15.3
63	12.3
80	16.2
100	23.0
125	29.3
160	34.3
200	37.5
250	40.2
315	41.4
400	47.8
500	52.2
630	52.4
800	56.7
1 000	58.3
1 250	59.8
1 600	59.6
2 000	55.2
2 500	43.5
3 150	41.0
4 000	47.4
5 000	52.0

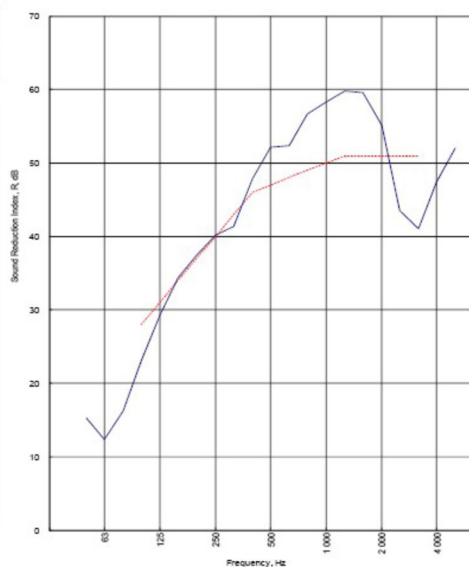

Rating according to BS EN ISO 717-1:2013  
 **$R_w$  (C;Ctr) = 47 (-2;-6) dB**  
 Max dev. 10 dB at 3 150 Hz

Evaluation based on laboratory measurement results obtained by an engineering method:

$C_{50-3150} = -15$ dB	$C_{50-5000} = -4$ dB	$C_{100-5000} = -2$ dB
$C_{10-50-3150} = -15$ dB	$C_{10-50-5000} = -15$ dB	$C_{10-100-5000} = -6$ dB

TESTED AT ONE OF THE UKAS ACCREDITED LABORATORIES BELOW

- B.T.C (H-Ref on Graph)
- B.R.E
- AIRO
- S.R.L

Customer: Voestalpine Metsec Plc

BTC 19435A: Page 9 of 12



SPEEDLINE Drywall Systems, Adsetts House, 16 Europa View, Sheffield Business Park, Sheffield, S9 1XH.

Tel: 0114 231 8030.

Email: [enquiries@speedlinedrywall.co.uk](mailto:enquiries@speedlinedrywall.co.uk)

(As per the requirements set out in ISO/IEC 17025:2017 regarding test data the results stated have been carried out by voestalpine Metsec plc as part of the contract to supply Speedline Metal Sections to SIG Plc)